

# Plate heat exchanger NIBE PLEX

NIBE PLEX is a plate heat exchanger with plates made from acid-resistant steel. It is insulated with ABS plastic. NIBE PLEX can be used as an intermediate heat exchanger for groundwater installations. Efficient insulation is included in this accessory kit.

- Intermediate heat exchanger for groundwater use
- Plates manufactured of acidproof steel
- Insulation included



# Domestic water exchanger/intermediate heat exchanger

- Plates made of acid-resistant steel (SS 23 43)
- The insulation consists of two 30 mm thick, compression-moulded halves made of polyurethane foam covered in ABS-plastic, equivalent to approx. 70 mm of mineral woll

## Plate heat exchanger for ground water systems

Ground water temperature in / out: 7 / 3 °C

Brine temperature: DT= 3 °C (DT - brine for 60 kW: 3.5 °C)

Brine - Ethanol / water: 28 / 72 %

<i>The heat pump's size kW</i>	<i>Cooling capacity at 5/35 °C kW</i>	<i>Plate heat exchanger NIBE PLEX</i>	<i>Flow (water) kg/s</i>	<i>Flow (brine) kg/s</i>	<i>Temperature (brine HP in) °C</i>	<i>Pressure drop (water side) kPA</i>	<i>Pressure drop (brine side) kPA</i>
5	4.7	310-40	0.28	0.37	3.8	2	4
6	6.3	310-40	0.37	0.50	3.3	3	7
8	7.8	310-60	0.46	0.62	3.7	2	5
10	9.6	310-60	0.57	0.76	3.3	3	7
12	10.9	310-80	0.65	0.86	3.6	3	5
15	14.3	310-80	0.85	1.10	3.2	5	8
17	15.4	322-30	0.91	1.20	4.1	11	23
24	22.0	322-30	1.30	1.70	3.8	21	43
30	29.3	322-40	1.70	2.30	3.9	22	49
40	37.7	322-60	2.10	3.00	4.1	15	35
60	52.7	322-60	3.30	3.60	3.7	35	49

# Technical data

## Dimensions

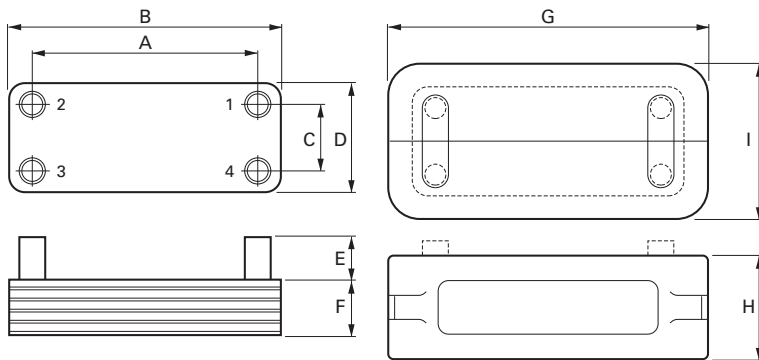

- 1** Flow A, in **2** Flow A, out  
**3** Flow B, in **4** Flow B, out

## Technical specifications

Max. operating pressure	3.0 MPa
Max operating temperature	185 °C
Min. operating temperature	-195 °C

Type	Conn. ext. thr.	Weight kg	A mm	B mm	C mm	D mm	E mm	F mm	G mm	H mm	I mm
NIBE PLEX 310-20	R 1"	3.8	250	311	50	112	45	58	360	112	182
NIBE PLEX 310-40	R 1"	6.4	250	311	50	112	45	106	360	160	182
NIBE PLEX 310-60	R 1"	9.0	250	311	50	112	45	154	360	209	182
NIBE PLEX 310-80	R 1"	11.6	250	311	50	112	45	202	360	257	182
NIBE PLEX 322-30	R 2"	13.0	520	616	92	191	55	76	670	160	244
NIBE PLEX 322-40	R 2"	16.5	520	616	92	191	55	92	670	247	244
NIBE PLEX 322-60	R 2"	23.5	520	616	92	191	55	133	670	247	244

## Exchanger data

Type	310-20	310-40	310-60	310-80	322-30	322-40	322-60
Temperature range °C	55 / 45 - 5 / 52						
Power (kW)	11	27	43	60	81	110	175
Pressure drop, primary (kPa)	6	8	11	16	38	45	50
Pressure drop, secondary (kPa)	1	1	1	1	2.5	3	3

Type	310-20	310-40	310-60	310-80	322-30	322-40	322-60
Temperature range °C	80 / 60 - 5 / 70				80 / 50 - 5 / 70		
Power (kW)	40	90	130	155	255	300	450
Pressure drop, primary (kPa)	18	23	21	22	42	37	37
Pressure drop, secondary (kPa)	1	2	2	2	11	10	10

NIBE Energy Systems  
Box 14, SE-285 21 Markaryd  
www.nibe.eu

PBD EN 1908-3 M10196

This product sheet is a publication from NIBE Energy Systems. All product illustrations, facts and data are based on current information at the time of the publication's approval. NIBE Energy Systems makes reservations for any factual or printing errors in this product sheet.

©2019 NIBE ENERGY SYSTEMS